



AIRPORT ADVISORY NOTICE

Notice #2020-015

Date: [Wednesday, April 08, 2020]
Time: 22:00 through 06:00 Nightly.
Subject: RWY 16R/34L FIVE (5) NIGHTLY CLOSURES FOR RUNWAY SHORTENING
(Revised schedule due to weather delays)

Runway 16R/34L will close for 5 total nights beginning April 8th as follows:

- April 8th, Wednesday night from 22:00 through April 9th, Thursday morning at 06:00.
- ****** April 9th, Thursday night from 22:00 through April 10th, Friday morning at 06:00. ******
- April 10th, Friday night from 22:00 through April 11th, Saturday morning at 06:00.
- April 13th, Monday night from 22:00 through April 14th, Tuesday morning at 06:00.
- April 14th, Tuesday night from 22:00 through April 15th, Wednesday morning at 06:00.
*** The above dates are planned weather permitting.*

****** If weather prevents work on the night of April 9th through April 10th then:

- April 12th, Sunday night from 22:00 through April 13th, Monday morning at 06:00, will be added to the closures to replace the night of work lost.

Runway "16R/34L Shortened" Configuration #1 goes into effect beginning Wednesday morning, April 15th, at 06:00 through May 28th.

Please see the attached "Runway 16R/34L Shortened Configuration #1"

NOTE:

For official NOTAM information, go to <https://pilotweb.nas.faa.gov/PilotWeb/> or contact a Flight Service Specialist at 1-800-WX-Brief (1-800-992-7433).

ADVISORY ISSUED BY	R. Nash
DATE ISSUED	4/8/2020
TIME ISSUED	09:15 AM

For additional information, contact the Van Nuys Airport at (818) 442-6506 or via facsimile at (818) 442-6751

VNY AIRPORT

TWY / RWY CLOSURE MAP

Taxiway A Rehabilitation Project

RUNWAY 16R/34L SHORTENED – Configuration #1

BEGINS APR. 15, 2020 - DURATION 42 DAYS

TWY A Rehab

Shortened Runway Configuration #1

Wednesday, Apr. 15, 2020 through

May 28, 2020

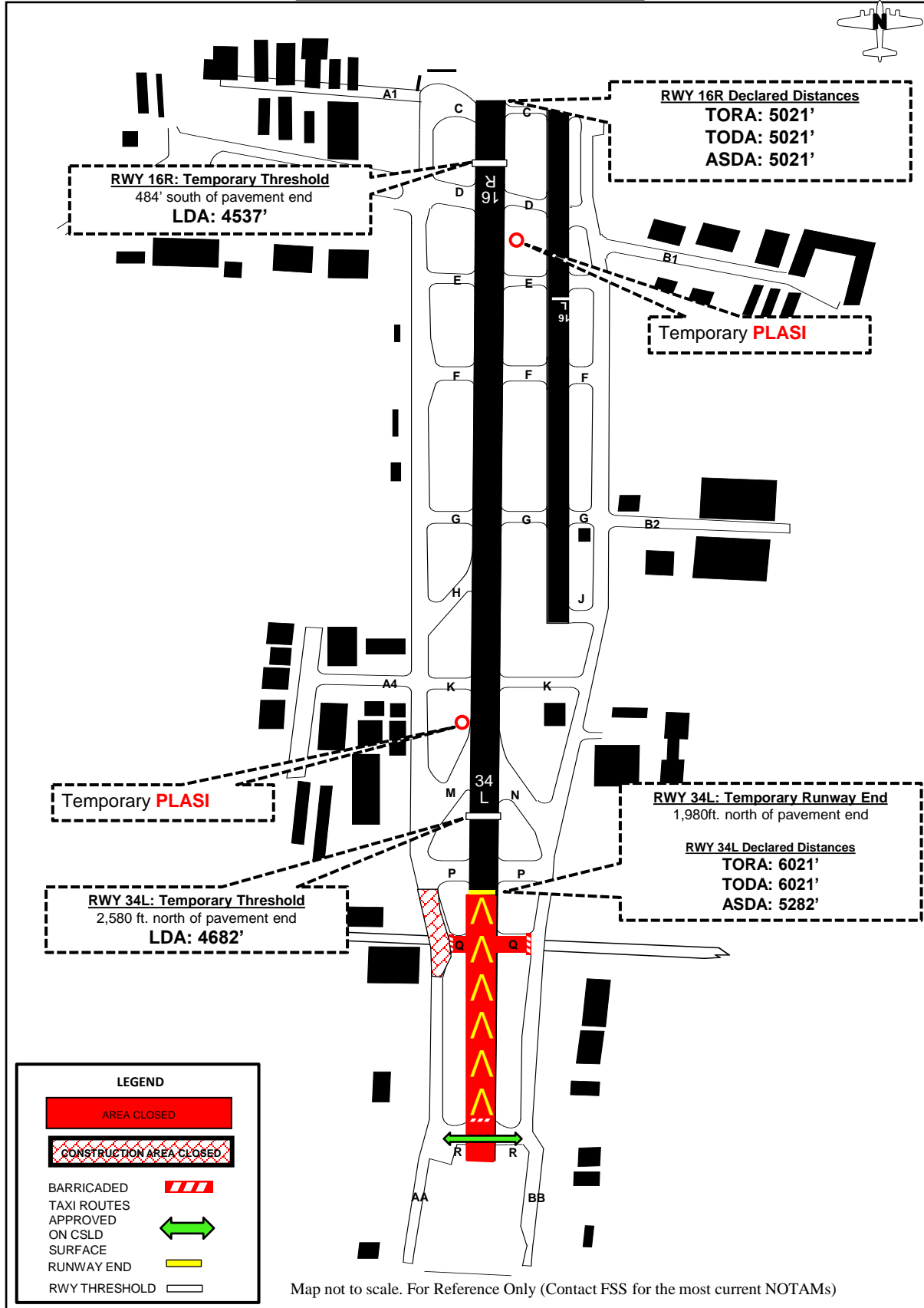

Map not to scale. For Reference Only (Contact FSS for the most current NOTAMS)